

Town of Rockland PLANNING BOARD

242 UNION STREET

ROCKLAND, MASSACHUSETTS 02370

schedule 6/30

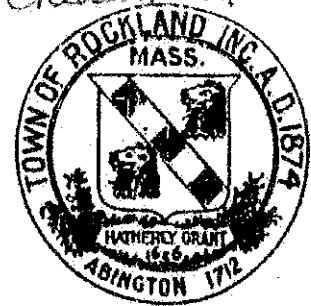

SITE PLAN REVIEW APPLICATION FORM

Date of Application: 6/2/99

Name of Applicant/Owner: ERNESTO CAPAROTTA

Address: 3 195 Libbey Pkwy Unit 2 Weymouth

Title of Development/Site: BANK Building, 1851 Hingham St

Assessors Map # 9 Lot # 9

Site Plan prepared by: MICHAEL T. SMITHER P.E.

Address: 18 MAIN ST. ESSEX MASS.

Plan and application was received by the Rockland Planning Board on the 11 day of AUG 19 99

FEE \$ 75

VOTE OF ROCKLAND PLANNING BOARD

On the 11 day of AUG 19 99 the Rockland Planning Board voted to:

1) _____ the Site Plan (approve/disapprove)

2) Reasons for Disapproval: _____

3) Approval of Site Plan with the following conditions.

SIGNATURE OF BOARD MEMBERS

[Signature]
CHAIRMAN

[Signature]
Vice Chairman

[Signature]
Clerk

[Signature]

Comments:
police to be notified before any excavations on hingham st.

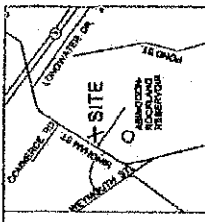

LOCUS PLAN

PLAN OF LAND
 IN
ROCKLAND, MASS.
 PREPARED BY:
NEPONSET VALLEY
SURVEY ASSOC., INC.
 48 WHITE STREET
 BOSTON 17, MASS.
 SCALE: 1" = 30'



UTILITIES

18 MARK STREET
 ESSEX, MASS.
 SHEET 1 OF 4 SHEETS
 JUNE 2, 1988
 REV. JULY 1, 1988

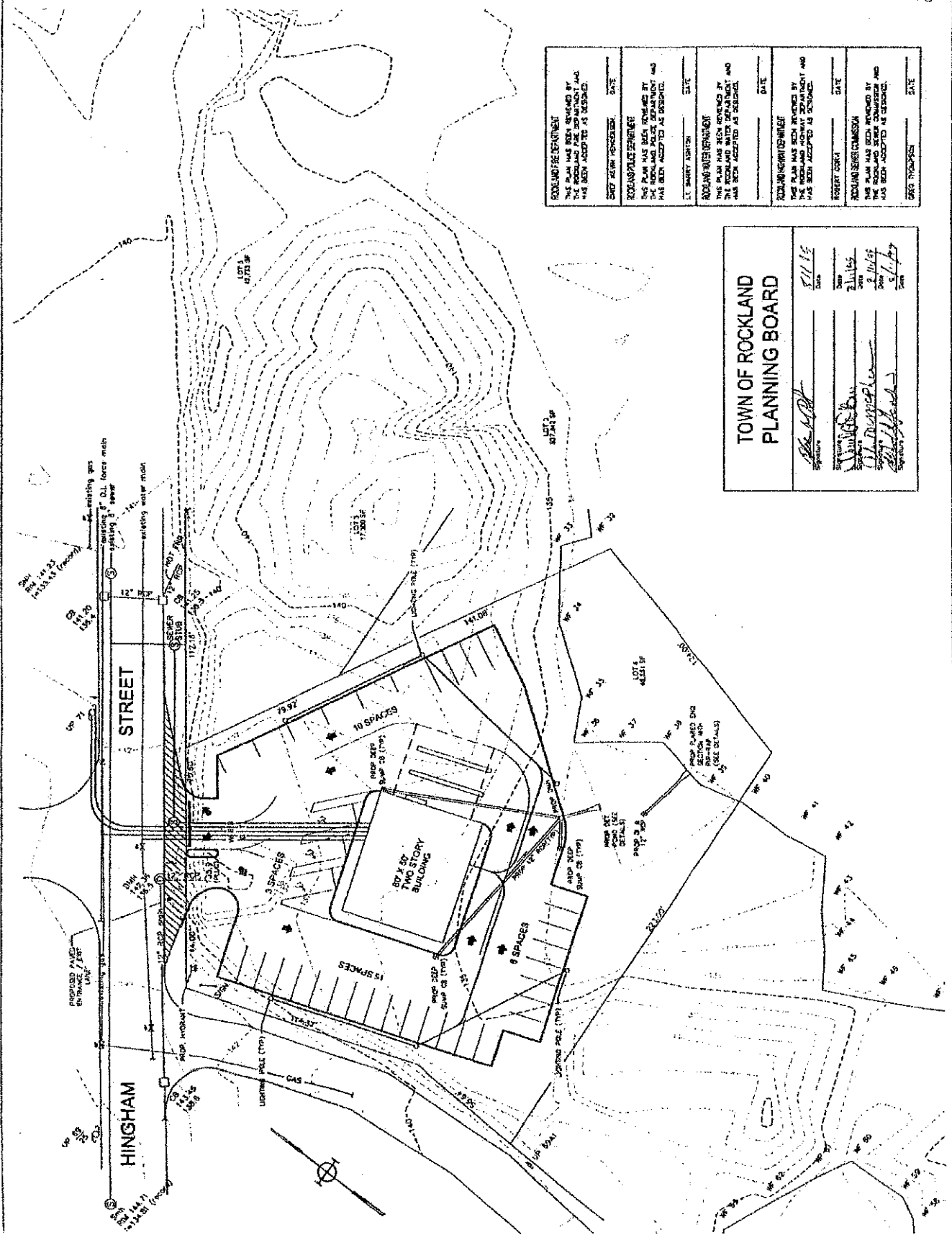

ROCKLAND FIRE DEPARTMENT THE PLAN HAS BEEN REVIEWED BY THE FIRE DEPARTMENT AND HAS BEEN ACCEPTED AS DESIGNED.	DATE
ROCKLAND POLICE DEPARTMENT THE PLAN HAS BEEN REVIEWED BY THE POLICE DEPARTMENT AND HAS BEEN ACCEPTED AS DESIGNED.	DATE
ROCKLAND WATER DEPARTMENT THE PLAN HAS BEEN REVIEWED BY THE WATER DEPARTMENT AND HAS BEEN ACCEPTED AS DESIGNED.	DATE
ROCKLAND HIGHWAY DEPARTMENT THE PLAN HAS BEEN REVIEWED BY THE HIGHWAY DEPARTMENT AND HAS BEEN ACCEPTED AS DESIGNED.	DATE
ROCKLAND ZONING COMMISSION THE PLAN HAS BEEN REVIEWED BY THE ZONING COMMISSION AND HAS BEEN ACCEPTED AS DESIGNED.	DATE

**TOWN OF ROCKLAND
PLANNING BOARD**

<i>[Signature]</i>	DATE
<i>[Signature]</i>	DATE
<i>[Signature]</i>	DATE
<i>[Signature]</i>	DATE

HINGHAM STREET

LOT SIZE
 LOT 4 = 44,351 SF = 1.07 ACRES
 32,385 SF UPLAND
 7,966 SF WETLAND

ZONING
 ZONED I/1
PAVED AREA
 0.60 ACRES

BUILDING
 50' X 80'

PARKING

BANK = 1 SPACE/100 SF X 2 FLOORS = 20 SPACES
 PLUS 1 SPACE/EMPLOYEE = 10 SPACES
 TOTAL REQUIRED = 30 SPACES
 TOTAL PROVIDED = 36 SPACES

PLAN OF LAND
 IN
ROCKLAND, MASS.
 PREPARED BY:
NEPONSET VALLEY
SURVEY ASSOC., INC.
 93 WHITE STREET
 QUINCY, MASS.
 SCALE 1" = 20'



BUILDING & PAVING
 MICHAEL T. DUMPER, P.E.
 18 MAIN STREET
 QUINCY, MASS.
 JUNE 2, 1989
 REV. JULY 1, 1989

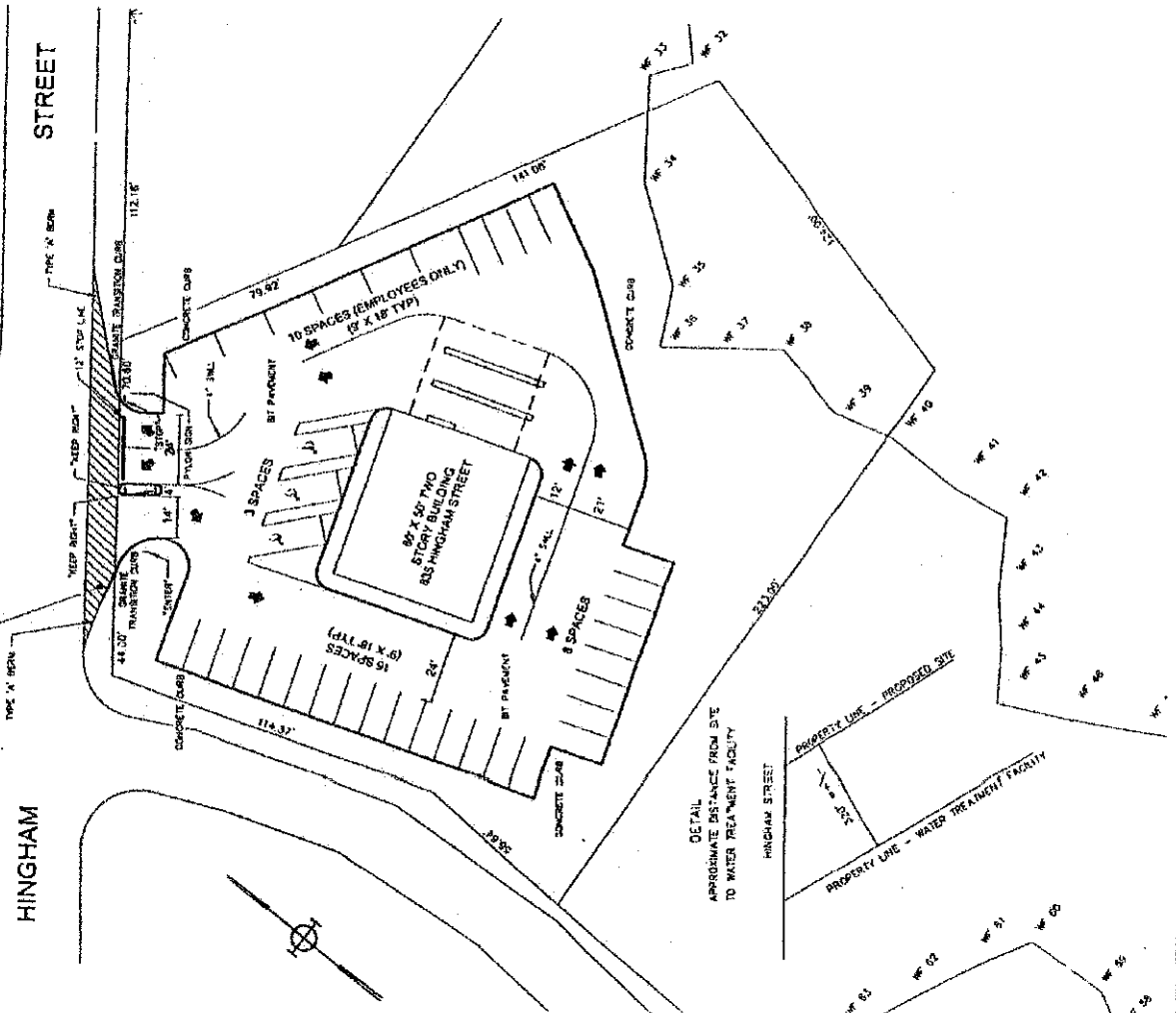

KINGHAM

STREET

DRIVE

SCALE 1"=20'

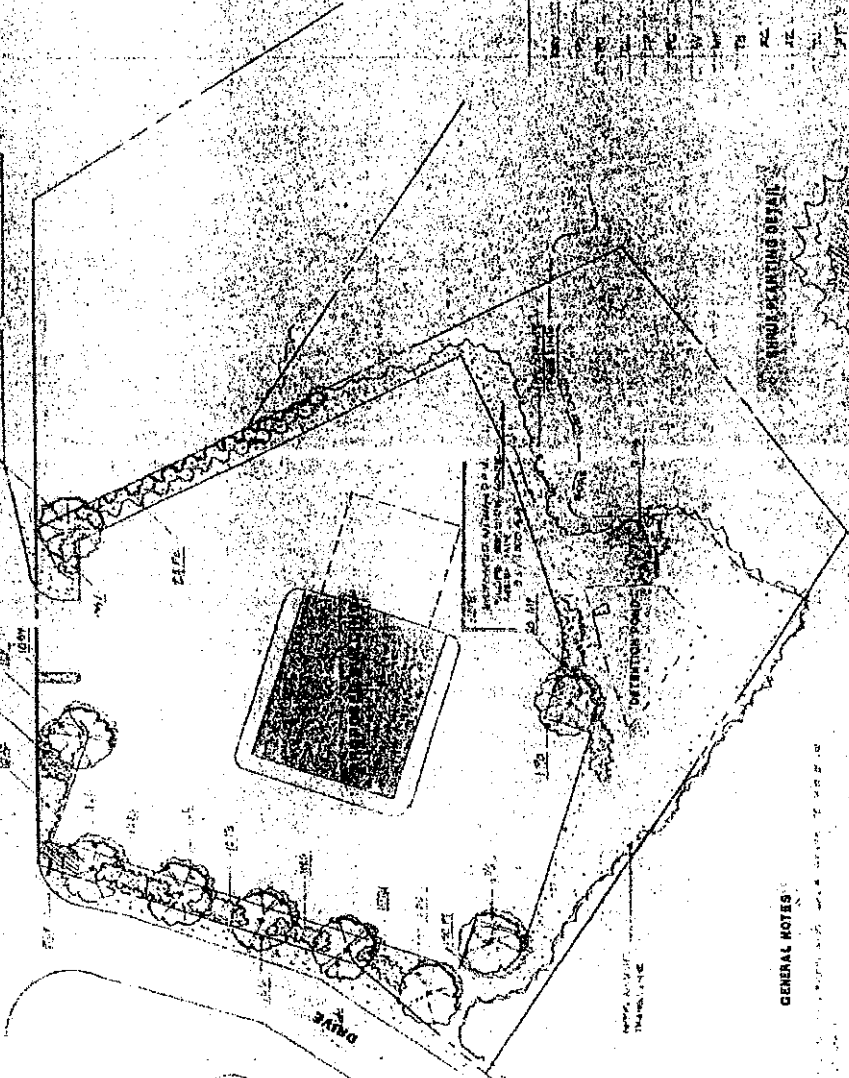

GENERAL NOTES

- 1. ALL PLANTINGS TO BE INSTALLED AS SHOWN ON THIS PLAN.
- 2. ALL PLANTINGS TO BE INSTALLED AS SHOWN ON THIS PLAN.
- 3. ALL PLANTINGS TO BE INSTALLED AS SHOWN ON THIS PLAN.

THRU-PLANTING DETAIL



PLANT LIST

NO.	SYMBOL	PLANT NAME	QUANTITY	REMARKS
1	(Symbol)	PLANT NAME	1	REMARKS
2	(Symbol)	PLANT NAME	1	REMARKS
3	(Symbol)	PLANT NAME	1	REMARKS
4	(Symbol)	PLANT NAME	1	REMARKS
5	(Symbol)	PLANT NAME	1	REMARKS
6	(Symbol)	PLANT NAME	1	REMARKS
7	(Symbol)	PLANT NAME	1	REMARKS
8	(Symbol)	PLANT NAME	1	REMARKS
9	(Symbol)	PLANT NAME	1	REMARKS
10	(Symbol)	PLANT NAME	1	REMARKS
11	(Symbol)	PLANT NAME	1	REMARKS
12	(Symbol)	PLANT NAME	1	REMARKS
13	(Symbol)	PLANT NAME	1	REMARKS
14	(Symbol)	PLANT NAME	1	REMARKS
15	(Symbol)	PLANT NAME	1	REMARKS
16	(Symbol)	PLANT NAME	1	REMARKS
17	(Symbol)	PLANT NAME	1	REMARKS
18	(Symbol)	PLANT NAME	1	REMARKS
19	(Symbol)	PLANT NAME	1	REMARKS
20	(Symbol)	PLANT NAME	1	REMARKS

THRU-PLANTING DETAIL

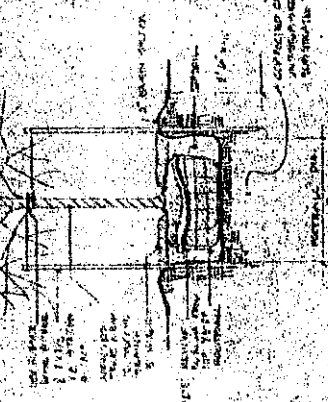

KINGHAM STREET LANDSCAPE ARCHITECTURE

SHEET 1

DATE 10/1/00

PLAN OF LAND
ROCKLAND, MASS.
 PREPARED BY
NEPONSET VALLEY
SURVEY ASSOC., INC.
 25 WHITE STREET
 QUINCY, MASS.
 APRIL 9, 1989
 SCALE 1" = 25'



**GRADING &
 DRAINAGE**

MICHAEL T. SWITZER, P. E.
 CIVIL ENGINEER
 18 MAIN STREET
 SAUGUS, MASS.
 SHEET 1 OF 4 SHEETS
 JUNE 2, 1989
 REV. JULY 1, 1989

